



Intermediate bracket orientation for ceiling, floor or wall mounting



Ceiling Mounting



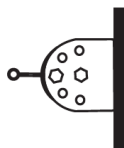

Floor Mounting

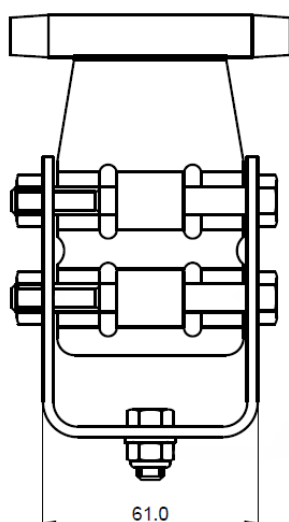
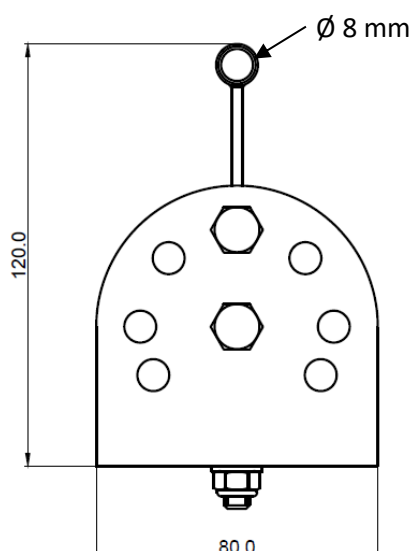

Wall Mounting



HS CODE
73269098
CARTON SIZE / PCS.
60 x 40 x 24 cm / 20
Compliance of Conformity 151014 (KS 4000 system – against EN795:2012 & CEN/TS 16415:2013)
DolomitiCert Scarl N°2008 Zona Industriale Villanova 32013 LONGARONE (BL) - Italy

REF.	FA 60 204 00
CE	EN 795:2012 Type C, TS 16415:2013 Type C (as part of KS 4000 system)
MAT.	 INOX ₃₁₆
DIM.	H 120 x W 80 x L 60 mm Ø 8 mm
	1x M12
R (kN) / MBS (kN)	15 kN / 26 kN
	0.57 KG

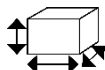

Fixations à utiliser
Fasteners to use
Fijaciones que deben usarse
Elemnetti di fissaggio da utilizzare
Zu verwendende Befestigungen

R (kN) / MBS (kN)

Résistance statique (en kN) / Résistance à la rupture
Static strength / Minimum Breaking Strength
Resistencia estática (en kN) / Resistencia a la ruptura (en kN)
Resistenza statica (in kN) / Resistenza alla rottura (in kN)
Statische Festigkeit (in kN) / Bruchfestigkeit (in kN)