

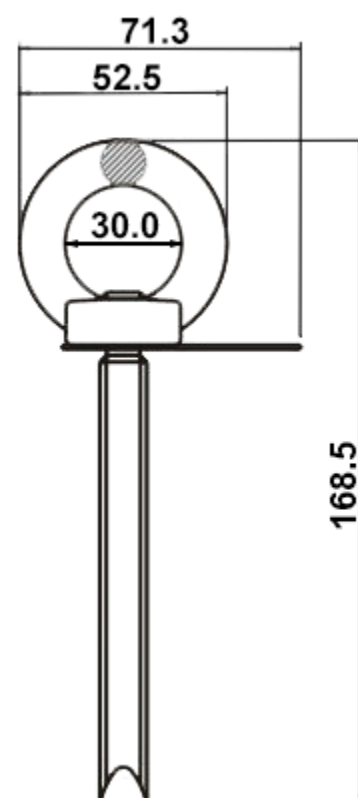



II2 G Exh IIC T6 Gb

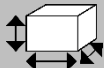

HS CODE
83081000
CARTON SIZE / PCS.
40 x 30 x 15 cm / 50
Certificate of Test n°SPC0208435/1241 Extension 1
Satra Technology Centre, N°0321 Wyndham Way, Telford Way, Kettering Northamptonshire, NN16 8SD, United Kingdom

REF.	FA 60 011 00
CE	EN 795:2012 Type A
	x1
MAT.	
DIM.	115 mm
R (kN) / MBS (kN)	12 kN / 23 kN
	M12 Ø 13 mm x 115 mm
+	EN 80079-36:2016 EN 80079-37:2016
	0.26 KG



R (kN) / MBS (kN)

Nombre d'utilisateurs
Number of users
Cantidad de usuarios
Quantità di utilizzatori
Anzahl der Benutzer

Résistance statique (en kN) / Résistance à la rupture
Static strength / Minimum Breaking Strength
Resistencia estática (en kN) / Resistencia a la ruptura (en kN)
Resistenza statica (in kN) / Resistenza alla rottura (in kN)
Statische Festigkeit (in kN) / Bruchfestigkeit (in kN)

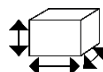

Fixations à utiliser / Dimensions de la structure d'accueil
Fasteners to use / Dimensions of the receiving structure
Fijaciones que deben usarse / Dimensiones de la estructura receptora
Elementi di fissaggio da utilizzare / Dimensioni della struttura ospitante
Zu verwendende Befestigungen / Abmessungen der Aufnahmestruktur